

ROD SEAL S72

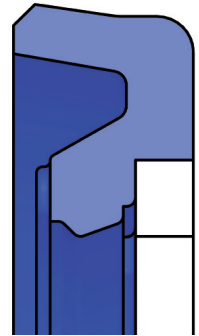

The single-acting rod seal S72 consists of an extrusion and wear-resistant TPU sealing element and a POM back-up ring, which protects against gap extrusion at high pressures and temperatures. These characteristics are the basic requirements for functional, long-lasting sealing solutions.

S72 is always used as a primary seal in combination with the secondary seal SNI30. Both facing surfaces have been provided with channels, which ensure a rapid pressure build-up. In the event of a pressure build-up between the primary and secondary seal, the sealing lip opens thanks to a specially developed geometry. This unburdens the secondary seal and produces less friction and wear, achieving a significantly longer lifespan.

APPLICATIONS

The S72 is designated for medium- and heavy-duty use. Its short-construction geometry, extrusion resistance and defined pressure release permit its use in numerous applications, including

- earth-moving equipment,
- agricultural machinery,
- truck loader cranes,
- industrial vehicles,

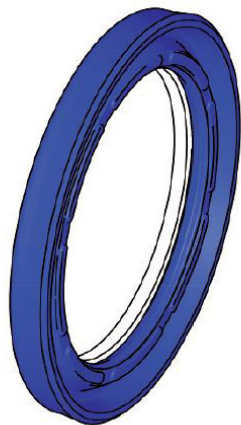

- injection molding machines and
- standard cylinders.

YOUR ADVANTAGES AT A GLANCE

- The sealing material polyurethane (TPU) stands out for its high wear and extrusion resistance as well as its compression set
- The back-up ring made of polyoxymethylene (POM) prevents gap extrusion at high temperatures and pressures
- TPU is resistant to hydraulic oils in accordance with DIN 51524 (Part 1-3) and flame-resistant hydraulic fluids (HFA, HFB, HFC), along with lubricating oils and greases based on petroleum oils
- Channels on the facing surfaces ensure a rapid pressure build-up
- Channels on the seal's backside allow a direct media backflow
- The sealing lip can bring about a pressure release in the event of an excessive pressure build-up
- Very low mounting effort



DICHTOMATIK
Any seal. Any time.

a brand of
 **FREUDENBERG**

CHARACTERISTICS

Sealing materials

The sealing element of the S72 is made of a blue TPU. The back-up ring is produced from white POM.

Assembly

With very little effort, this two-piece seal can be installed in closed grooves. Professional mounting can only be ensured with mounting aids. This will prevent damage to the seal during installation.

Dimensions

The currently available dimensions can be found on our online ordering platform **EASY** and in our webshop at www.dichtomatik.com.

Operating limits

Pressure (MPa)	40 to a maximum of 60	
Operating temperature range (°C)	-30 to +100	
Sliding Speed (m/s)	≤ 0,5	

Design guideline

Rod $\varnothing d$	< 38	≥ 40
C chamfer	5	6

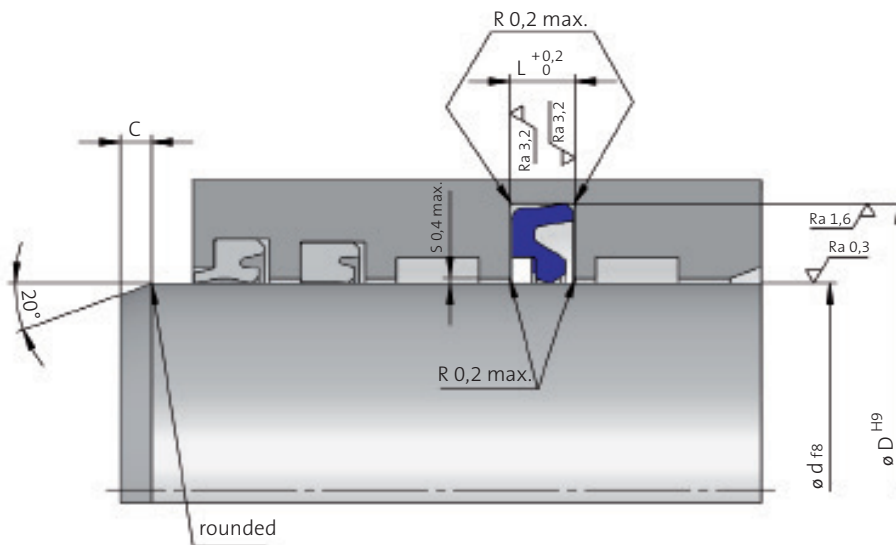

Installation space according to ISO 7425/2 or 5597-1

The information contained herein is considered to be reliable, but no assurances, warrants or guarantees whatsoever, of any kind, are provided with regard to their correctness or suitability for any purpose. The information reproduced herein is based on the current state of the technology and is not necessarily indicative of the performance of the end product. Complete testing and the performance of the end product are the user's responsibility.

www.dichtomatik.com