

SPOR 31

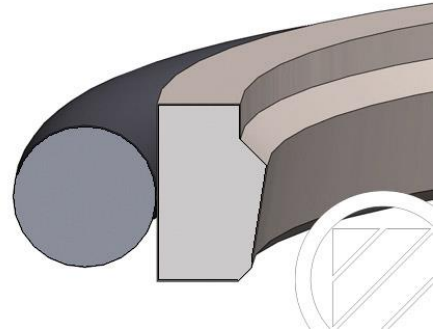

DESCRIPTION

Product group: rod seal
Design: POR PTFE seal with an O-ring energising element
Profile no.: 31
Specification: E suitable for one-sided pressure load
Seal material: PTFE
O-ring material: NBR

OPERATIONAL APPLICATION LIMITS

Pressure (MPa): ≤ 40
 Temperature (°C): -30 to $+100$
 Running speed (m/s): ≤ 15

MEDIA

- Hydraulic oils acc. to DIN 51524 Part 1 – 3
- Lubricating oils
- Mineral oil based lubricating greases
- Highly non-flammable hydraulic fluids HFA, HFB, HFC acc. to VDMA 24317

FUNCTION

The SPOR seal consists of a PTFE sealing element, which is energised by an O-Ring. This results in an exceptionally good sealing function under high loads and good static sealing performance. The SPOR 31 design can only be used in single-acting applications. The SPOR 31 is frequently used in tandem or in combination with other sealing elements as the primary or secondary seal in order to guarantee no leakage.

INSTALLATION

For small diameters, axially accessible installation housings are required. For larger diameters, the seals can be installed in closed installation housings. Subsequent calibration is necessary.

REMARKS

The standard for this design is a combination of PTFE-Bronze/NBR 70. Depending on the area of application, other materials such as PTFE-Glass, PTFE-Graphite and PTFE-carbon for the seal element and EPDM, FKM, VMQ etc. for the energising element are available. Sufficient guiding of the rod using suitable guide elements is necessary.

